

Fibertherm protect 265

Plasterable wood fiber panels for external/internal insulating coating systems with 265 kg/m³ density

Beton Wood

Specification

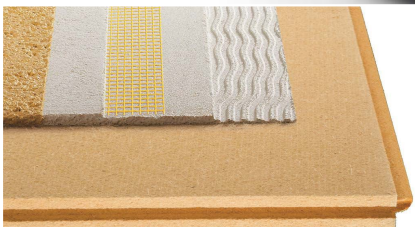

HIGH PERFORMANCE EXTERNAL AND INTERNAL THERMAL INSULATING COATING SYSTEM

Supply and installation of the thermo-acoustic insulation in external and internal insulating coating systems with highly breathable wood fiber panels FiberTherm Protect available with sharp or tongue&groove interlocking edges for easier installation.

The panels are realized in wood fiber directly plasterable with $\delta=265 \text{ Kg/m}^3$ density, the panels have a high compressive strength and they are produced with wet system, according to the standards EN 13171 and EN 13986 under constant quality control.

The material has the following thermodynamic characteristics: density $\delta=265 \text{ Kg/m}^3$, declared thermal conductivity $\lambda=0,048 \text{ W/mK}$, resistance to vapor penetration coefficient $\mu=5$, specific heat capacity 2100 J/kgK , fire class E according to EN 13501-1, CE certified. The dimensions of the panels correspond to ... mm for a thickness of ... mm. The wood used in panel processing comes from forests controlled by reforestation cycles according to the FSC (Forest Stewardship Council®) guidelines.

Head office:
Via Falcone e Borsellino, 58
I-50013 Campi Bisenzio (FI)

T: +39 055 8953144
F: +39 055 4640609

info@betonwood.com
www.betonwood.com

FTHP IR.18.02

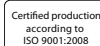

Beton Wood

For more informations about the uses and the installation, our offices are ready to answer your questions on www.fibradilegno.com